

BRIDGES

TYPES OF BRIDGES

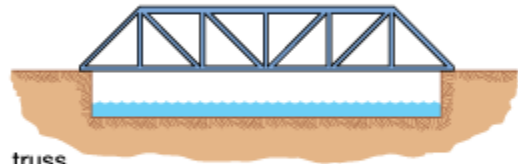

beam



truss



cantilever

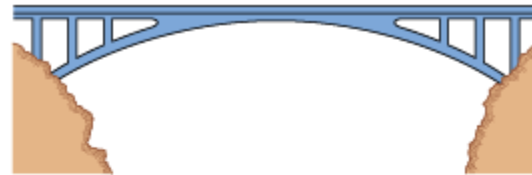

arch



suspension



cable-stay

© 2012 Encyclopædia Britannica, Inc.

GUANKOUYA BRIDGE (CHINA)



CHESAPEAKE BAY BRIDGE (USA)



LUANYUNG BRIDGE (CHINA)



Humber Bay Bridge



Pont du Guard, France



Clifton suspension bridge, UK



Menai Suspension Bridge, Wales



Shanghai Port bridge





Leedle Mill Truss Bridge, USA



Tacoma Truss bridge



Pin Scotland Bridge



Pont de Quebec, Canada



Pontoon bridge, Willemstad



